

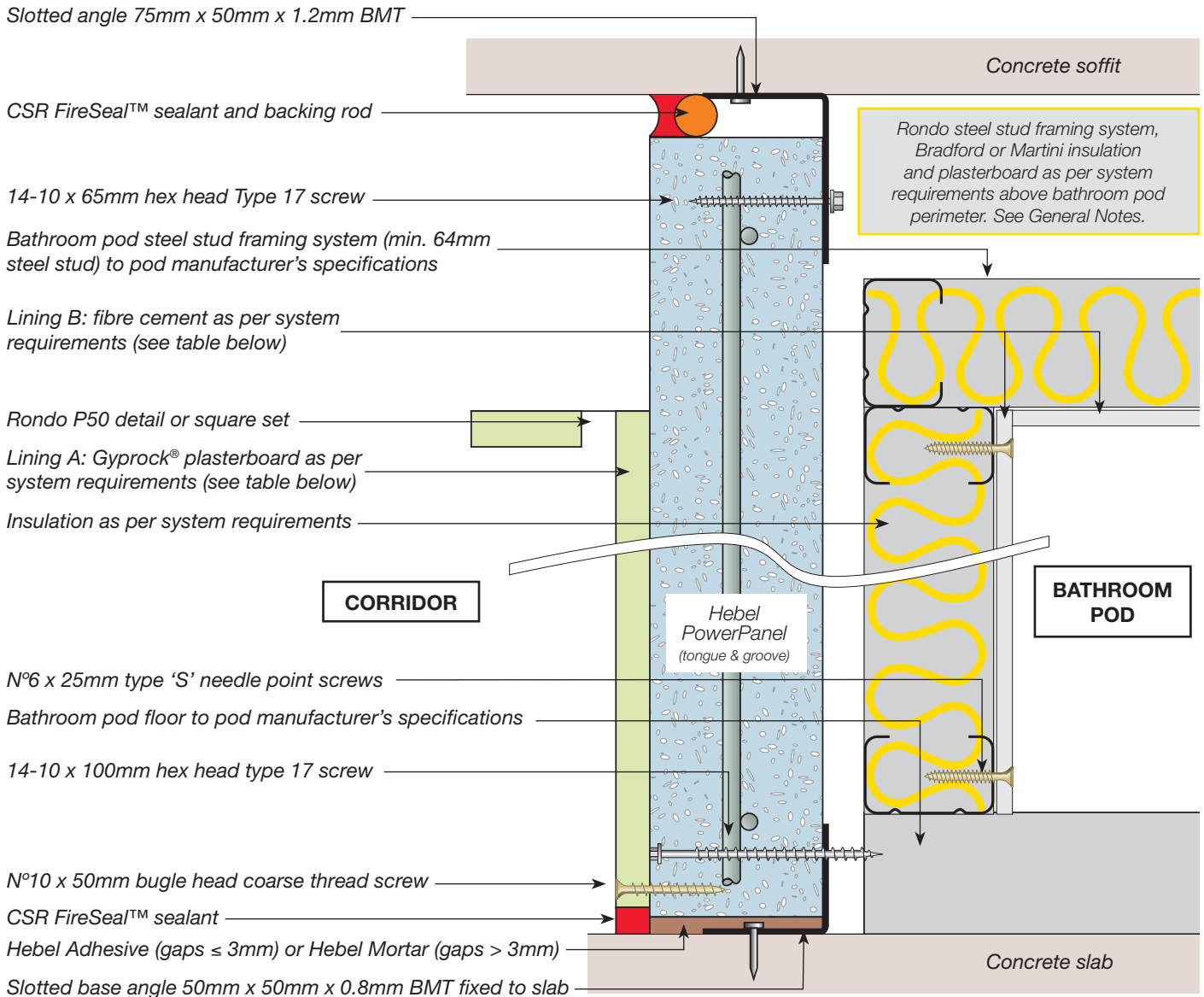

CORRIDOR WALL

adjacent to bathroom pod



System	Application	FRL ^(A)	Wall lining A	Cavity width (mm)	Wall lining B	Insulation ^(C)	Acoustic rating R _w ^(B)	Wall width (mm)
HEB 1450	Corridor to Bathroom Pod	-/90/90 for wall heights up to 3.3m	13mm Gyprock CD	10	6mm fibre cement	75mm Bradford Acoustigard 11, 75mm Martini Prime 75, or 70mm spray foam (11kg/m ³)	≥50dB	168

- NOTES:
- (A) FRL values should be read in conjunction with CSIRO fire opinion FCO-3035. For walls >3.3m and ≤ 4.65m, Hebel PowerPanel caged tongue & groove will achieve a FRL of -/120/120.
 - (B) Acoustic values should be read in conjunction with Acoustic Logic acoustic assessment report 20151586.3/0707A/R5/GW.
 - (C) Where bathroom pods are installed alongside a facade wall and one pod wall forms part of the facade wall construction, the insulation used in this wall must be deemed non-combustible.

GENERAL NOTES

- Insulation and plasterboard are required around bathroom pod perimeter to concrete soffit.
- For more construction and product information refer to Hebel Design & Installation Guide for High Rise Apartments Hotels Student Accommodation Commercial - Corridor, Intertenancy, Shaft & Service Walls (HELIT117).



For more information or to speak to a Hebel representative call:

1300 369 448 or www.hebel.com.au

