

Building external walls with Hebel PowerPanel^{XL}

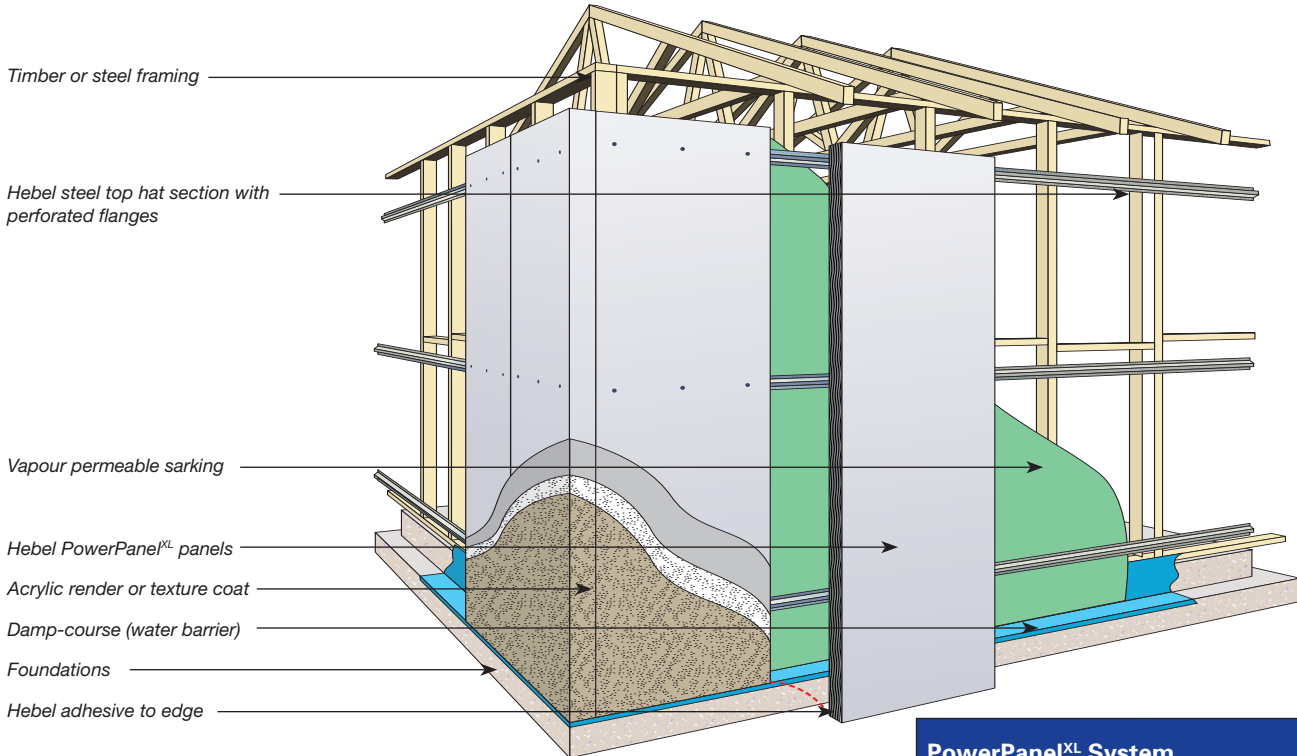

A fast, solid and efficient way to build

PowerPanel^{XL} external wall system has been specifically developed to provide a secure solid facade that goes up fast.

The system consists of 75mm thick, steel-reinforced PowerPanel^{XL} panels, fixed vertically to steel horizontal top hats attached to the load-bearing timber or steel frame.

Hebel PowerPanel^{XL} combined with the perforated steel top hat and hex head fixing system, speeds up the installation process.

Hebel PowerPanel^{XL} is ideal for houses and low-rise multi-residential applications, including extensions and re-cladding of existing homes. Hebel PowerPanel^{XL} is easy to install on two-storey dwellings.

Benefits of contracting with PowerPanel^{XL}

- The steel reinforced aerated concrete panels, when finished with acrylic coatings are strong, solid and highly durable
- Steel reinforcing within the PowerPanel^{XL} is specially coated to prevent corrosion and provides maximum durability
- A non-combustible system with an FRL of 180/180/180
- Outstanding thermal and acoustic insulation qualities increase levels of comfort and save on energy, heating and cooling costs

PowerPanel ^{XL} System	
Fire	180/180/180
Thermal	R1.54 to R3.54
Wall Thickness	165mm to 205mm*

*Depending on stud, cavity and Top Hat selection

- Hebel has substantial environmental benefits, such as lower embodied energy and higher thermal performance than traditional masonry
- Fast and efficient - 2 people can install up to 150m² within 3 days depending on site conditions
- Supply and install services are available through specialist Hebel installers



HEBEL. Better by design. Better to build with. Better for the future.



A beautifully rendered surface with clean architectural lines

You'll love the rendered finish, clean architectural lines and design flexibility of Hebel. With Hebel you'll enjoy the extra comfort of a home that's better to live in and a sustainable choice compared to bricks.

The attractive street appeal of clean lines and the contemporary rendered finish of Hebel, with your choice of colours and textured finishes, make for a stylish and refreshing alternative to the look of traditional brick. Hebel can even be customised with routed patterns to enhance your home design and add a distinctive style.



Hebel panels contain steel reinforcement for added strength and are available in a variety of sizes.

An innovative, sustainable and proven building product, Hebel PowerPanel^{XL} is a strong steel reinforced AAC panel and has impressive benefits:



SOLID AND STRONG

Hebel 75mm steel reinforced PowerPanels provide the solid feel, security and peace-of mind associated with traditional bricks. In fact, independent tests show that a rendered Hebel wall has similar impact resistance to brick.



FASTER CONSTRUCTION TIME

This lightweight panel, combined with Hebel's perforated steel top hat fixing system, speeds up installation with less fatigue. Fast and efficient to install (two people can install up to 150m² in three days depending on site conditions).



COMFORTABLE LIVING ENVIRONMENT

Enhanced insulation performance up to 3 times that of brick. The thermal efficiency reduces the reliance on heating and cooling appliances with the potential of lower energy costs.



BETTER ACOUSTICS

Keeping the noise of the exterior world out and your home and outdoor living areas a little more peaceful and quiet.



FIRE RESISTANT

Non-combustible and renowned for its highly fire resistant properties, suitable for all Bushfire Attack Levels under AS 3959-2009.



SUSTAINABILITY FOR A BETTER WORLD

Environmentally friendly, Hebel products and systems are the sustainable choice. Independent testing shows that overall, Hebel has a 30% lower environmental impact than concrete. Using over 60% less embodied energy, and producing at least 55% less greenhouse emissions than concrete, Hebel is the cleaner, greener choice.



PROVEN AND BACKED BY CSR

Hebel products and systems are designed, developed and warranted in Australia by CSR.

Phone 1300 369 448 Email: info@hebel.com.au
www.hebel.com.au

CSR Hebel app – download at the app store or on android

Hebel® is a registered trademark of the Xella group. CSR Building Products Ltd is an exclusive licensee of Xella. CSR Hebel is a business of CSR Building Products Ltd ABN 55 008 631 356.

hebel[®]
The better way to build

