

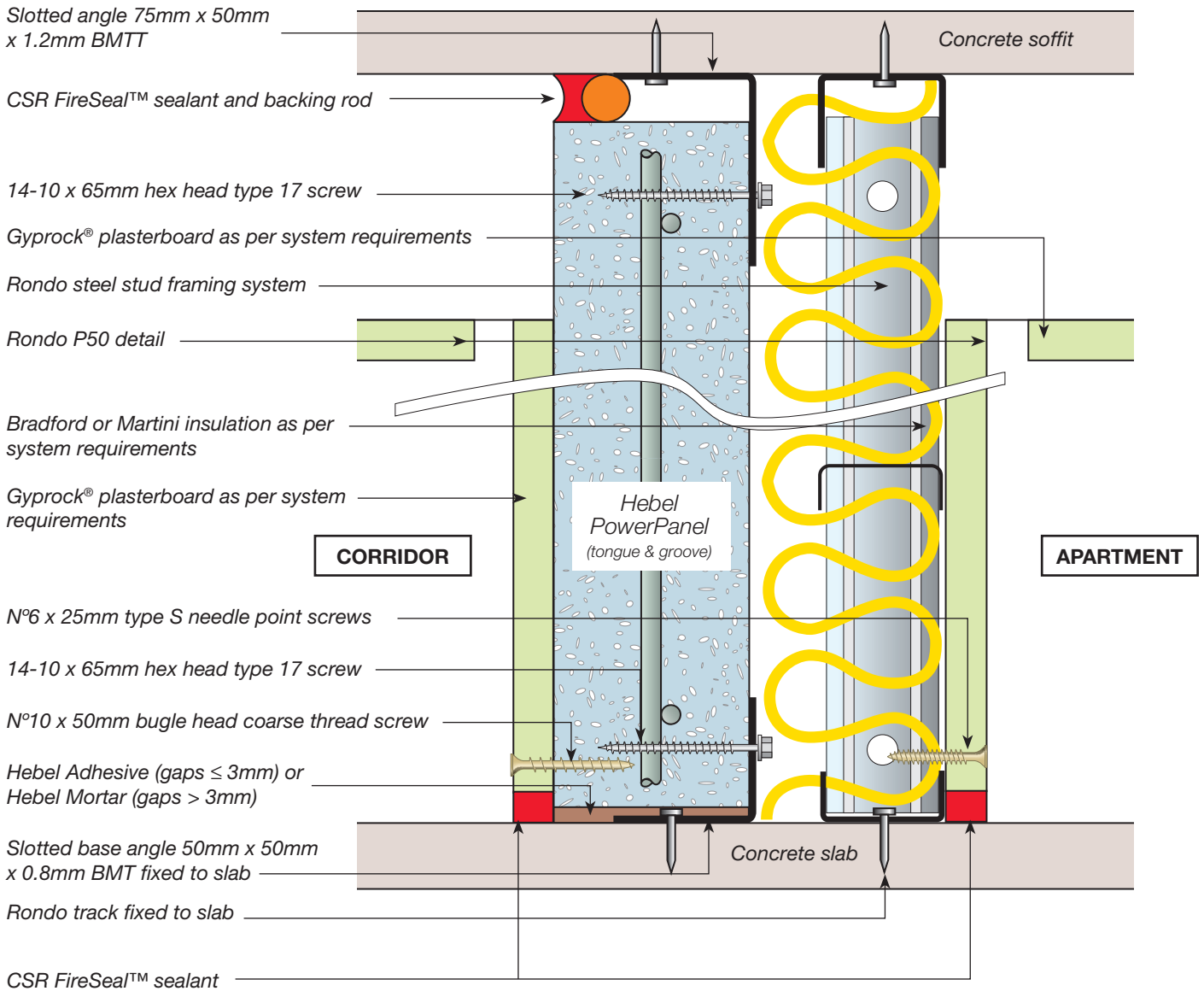

CORRIDOR WALL

concealed water services one side



| System | Application | FRL ^(A) | Wall linings ^(D) | Cavity width (mm) | Insulation | Acoustic rating Rw ^(C) | Wall width (mm) |
|----------|-------------|-------------------------------------|---|-------------------|---|-----------------------------------|-----------------|
| HEB 1168 | Dry to Dry | -/90/90 for wall heights up to 3.3m | Both Sides 13mm Gyprock CD | 15 | 50mm Bradford Acoustigard 11 or 50mm Martini Prime | 58 | 180 |
| HEB 1169 | Dry to Wet | | Corridor Side – 13mm Gyprock CD Stud Side – 13mm Aquachek ^(B) | | | 59 | 180 |

NOTES:

- (A) For wall heights higher than 3.3m, caged tongue & groove PowerPanel can be used and will achieve a FRL of -/120/120 for wall heights up to 4.65m (vertically). Also see Construction details section.
- (B) 13mm Aquachek can be replaced by 9mm FC Sheeting and achieve the same Acoustic & Fire Rating Levels.
- (C) Rw values are based on acoustic opinion 20140366.9/1606A/R8/GW provided by Acoustic Logic Consultancy Pty Ltd.
- (D) The minimum mass of plasterboard must be 8.5kg/m².

GENERAL NOTES:

- 1. HEB 1168-1169 are designed to resist a maximum ultimate lateral pressure of 0.50kPa. Contact Hebel Technical Services if lateral pressures exceed 0.50kPa.



For more information or to speak to a Hebel representative call:

1300 369 448 or www.hebel.com.au

