

# Hebel PowerPanel<sup>50</sup> Dual Zero Boundary Wall Systems

Simple and easy to install. Codemark for easy compliance

Hebel PowerPanel<sup>50</sup> has been developed and tested for low rise Dual Zero Boundary wall systems, which are warranted by CSR.

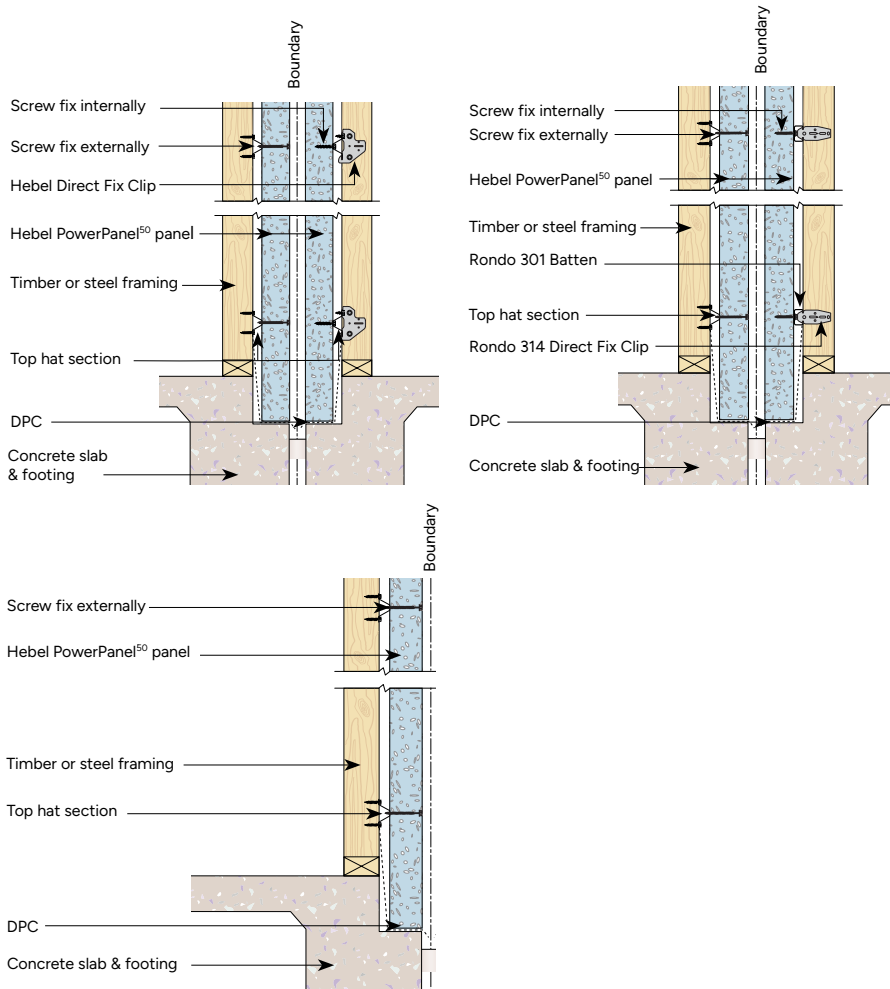

-  **Not damaged by weather during installation**

---

-  **Strong and solid**

---

-  **Quality and speed**

---

-  **Energy efficient**

---

-  **Eco-friendly**

---

-  **Noise reduction**

---

-  **Fire resistant**

---

-  **Proven**

## PowerPanel<sup>50</sup> Dual Zero Boundary Walls

Construction of the non-loadbearing Powerpanel<sup>50</sup> Dual Zero Boundary wall is achieved by installing 50mm thick Hebel panels vertically - using Hebel Top Hats and Direct Fix Clips to fix panels to the structural timber or steel frame. When using the Hebel Hoist system all frames can be installed first.

■ **Fire rating:** Up to 90/90/90 when subjected to an external fire source

## PowerPanel<sup>50</sup> Standard Panel Sizes

50mm thick x 600mm wide x 2400mm, 2550mm, 2700mm, 2850mm and 3000mm long.

- Fast and easy system to install with Hebel Hoist
- Perfect solution for separate title construction
- Narrow wall widths
- Hoist system enables all frames to be constructed first
- Simple, proven system



# Hebel PowerPanel<sup>50</sup> Dual Zero Boundary Wall Systems

Simple and easy to install. Codemark for easy compliance

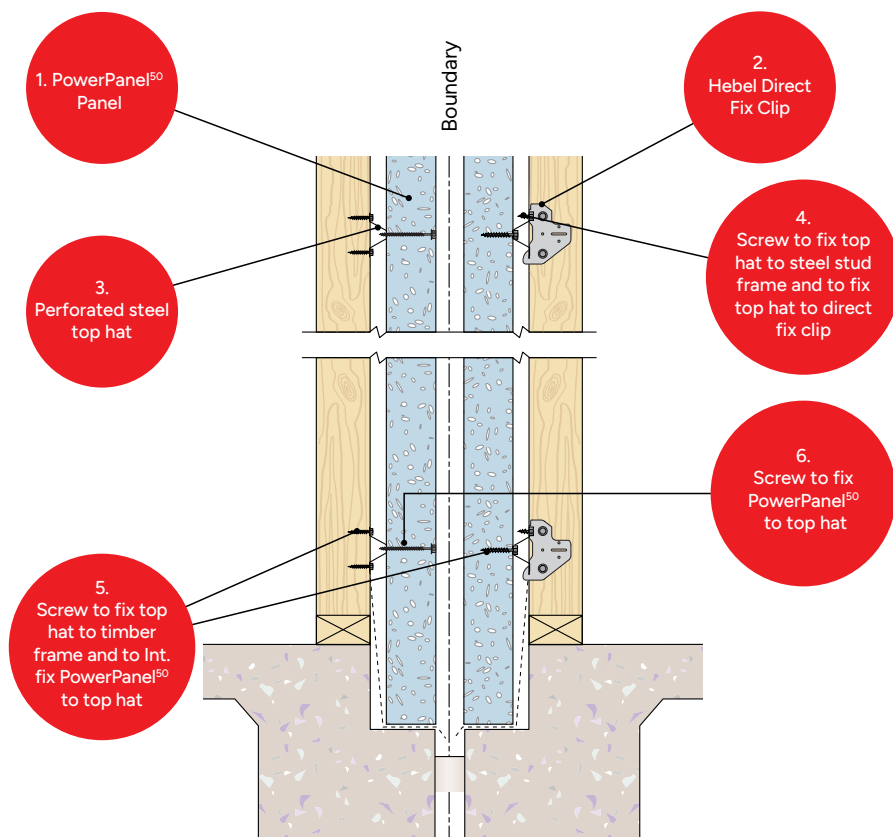

ITEM	DESCRIPTION	LOCATION
1	Hebel PowerPanel <sup>50</sup>	Entire wall area
2	Hebel Direct Fixing Clip - (Exclusive to Hebel Dual Zero Boundary Wall)	Attaching top hat for 50mm Dual Zero Boundary Wall System
3	Perforated Top Hat 24mm x 4.8m x 0.42mm BMT OR 35mm x 4.8mm x 0.55mm BMT	Attaching PowerPanel <sup>50</sup> to frame
4	Screw 10-16 x 16 Hex Head self-drilling	Fixing top hat to steel stud frame and fix top hat to direct fix clip
5	Screw 12-11 x 35 Hex Head Type 17	Fixing top hat to timber frame and Int. fix PowerPanel <sup>50</sup> to top hat
6	Screw 14-10 x 65 Hex Head	Fixing PowerPanel <sup>50</sup> to top hat

For more information contact 1300 369 448 [www.hebel.com.au](http://www.hebel.com.au)



HELI182NOV25